

J. Blair 0

Sixth St.

S. 43° 20' E

curb

205'

S. 46° 40' E

125'

N. 43° 20' E

15' public alley

40'

Lot 187
Page 5, Sect. 47
Easing Top.
Tax maps

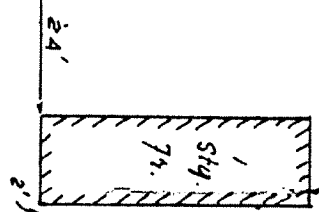

N. 46° 40' W

125'

No. 1628 Sixth Street

Survey of Property

Easing Top. Merces Co. N.Y.

Survey by Louis Lehman, P.E. #5379

Oct. 23, 1973 Scale 1"=30' No. 20710-A

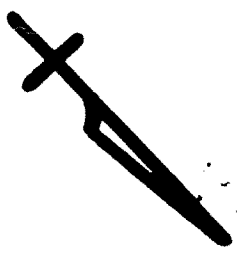

Louis Lehman
Louis Lehman, N.Y. P.E. #5379

Columbia Ave.